

RUNWAY S PRO

“When designing Runway, we took a holistic approach, starting from the effect of lighting by creating a family of both linear lighting - creating general light and spotlights - creating accent lighting. Tying it all together with the golden proportions, curvatures and connectivity. Design worthy the attention of a fashion runway.”

LED-spotlight with passive cooling system.
 Die cast aluminium body, powder coat painted.
 Integral heatsink. Premium in-track driver.
 Low ripple output current <4% to assure camera and scanner friendly performance.
 Rotation 355°. Vertical adjustment +/- 90°.
 Track mounted with 3-circuit universal adapter.



Class of protection	IP20, class I
Colours	White, black
Weight total	700g
Reflector	High purity MIRO segmented
Lifetime LED	100 000h L90/B50 at Ta 25°C
Driver h/max failure	50 000h/10% at Ta 25°C
Mounting	3-circuit universal driver-adapter
Voltage	220-240V 50/60hz
Qty/MCB 16A type B	Max 60pcs (19W) - 36pcs (32W)
Ripple out. current	< 4%. Flicker-free performance
Colour consistency	2 SDCM (930) 3 SDCM (940)
Photobiological safety	RG1
Design	Jesper Ståhl
Dimming	Not dimmable

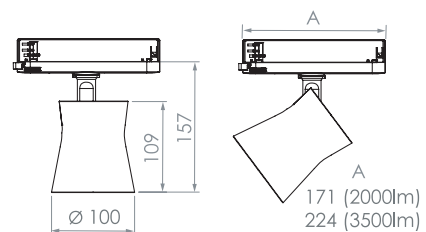

- White
- Black

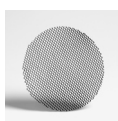

Accessories

Honeycomb louvre **225091**

RUNWAY S PRO

Description	Reflector	CCT (K)	CRI	Lumen	Load	Lumen	Lm/W	○ White	● Black
				LIGHTSOURCE				ART. No.	
WARM WHITE 3000K (930)									
RUNWAY S Pro 2000lm SP 930	Spot 15°	3000K	92	2520	19W	2310	121	225110	225114
RUNWAY S Pro 2000lm ME 930	Medium 25°	3000K	92	2520	19W	2310	121	225111	225115
RUNWAY S Pro 2000lm FL 930	Flood 40°	3000K	92	2520	19W	2310	121	225112	225116
RUNWAY S Pro 2000lm WFL 930	Widefl. 60°	3000K	92	2520	19W	2310	121	225113	225117
WARM WHITE 3000K (930) - Beam Spread Data									
Spot		2000lm		3500lm					
m	∅	Lux	Lux	m	∅	Lux	Lux		
1	0,28	14984	22780	1	0,42	8290	12681		
2	0,56	3746	5695	2	0,84	2073	3170		
3	0,84	1665	2531	3	1,25	921	1409		
4	1,12	937	1424	4	1,70	518	793		
Medium		2000lm		3500lm					
m	∅	Lux	Lux	m	∅	Lux	Lux		
1	0,42	8290	12681	1	0,74	5216	7979		
2	0,84	2073	3170	2	1,42	1304	1995		
3	1,25	921	1409	3	2,18	580	887		
4	1,70	518	793	4	2,91	326	499		
Flood		2000lm		3500lm					
m	∅	Lux	Lux	m	∅	Lux	Lux		
1	0,74	5216	7979	1	1,19	2416	3696		
2	1,42	1304	1995	2	2,38	604	924		
3	2,18	580	887	2,5	2,97	268	411		
4	2,91	326	499	3	3,56	151	231		
Wideflood		2000lm		3500lm					
m	∅	Lux	Lux	m	∅	Lux	Lux		
1	1,19	2416	3696	1	1,19	2416	3696		
2	2,38	604	924	2	2,38	604	924		
2,5	2,97	268	411	2,5	2,97	268	411		
3	3,56	151	231	3	3,56	151	231		
NEUTRAL WHITE 4000K (940)									
RUNWAY S Pro 2000lm SP 940	Spot 15°	4000K	92	2460	19W	2280	119	225150	225154
RUNWAY S Pro 2000lm ME 940	Medium 25°	4000K	92	2460	19W	2280	119	225151	225155
RUNWAY S Pro 2000lm FL 940	Flood 40°	4000K	92	2460	19W	2280	119	225152	225156
RUNWAY S Pro 2000lm WFL 940	Widefl. 60°	4000K	92	2460	19W	2280	119	225153	225157
NEUTRAL WHITE 4000K (940) - Beam Spread Data									
Spot		2000lm		3500lm					
m	∅	Lux	Lux	m	∅	Lux	Lux		
1	0,28	14701	22515	1	0,42	8193	12548		
2	0,56	3675	5629	2	0,84	2048	3137		
3	0,84	1633	2502	3	1,25	910	1394		
4	1,12	919	1407	4	1,70	512	784		
Medium		2000lm		3500lm					
m	∅	Lux	Lux	m	∅	Lux	Lux		
1	0,42	8193	12548	1	0,74	5163	7908		
2	0,84	2048	3137	2	1,42	1291	1977		
3	1,25	910	1394	3	2,18	574	879		
4	1,70	512	784	4	2,91	323	494		
Flood		2000lm		3500lm					
m	∅	Lux	Lux	m	∅	Lux	Lux		
1	0,74	5163	7908	1	1,19	2388	3818		
2	1,42	1291	1977	2	2,38	597	954		
3	2,18	574	879	2,5	2,97	265	424		
4	2,91	323	494	3	3,56	149	239		
Wideflood		2000lm		3500lm					
m	∅	Lux	Lux	m	∅	Lux	Lux		
1	1,19	2388	3818	1	1,19	2388	3818		
2	2,38	597	954	2	2,38	597	954		
2,5	2,97	265	424	2,5	2,97	265	424		
3	3,56	149	239	3	3,56	149	239		
Spectral power distributions									
3000K 930					Spectral power distributions				
4000K 940					Spectral power distributions				

Luminous flux and connected electrical load are subject to an initial tolerance of +/- 5%. Tolerance of colour temperature: +/-150 K. Tolerance of CRI +/- 1,5. Values apply to an ambient temperature of 25°C.